



Battery Equalizer PLC-10 User Manual

What is the Battery Equalizer?

Battery equalizer is used to maintain the charge and discharge balance between each battery in the battery pack connected in series or parallel. During the operation of the battery connected in series or parallel, due to the difference in the chemical composition and temperature of the battery cells, it will cause The charging and discharging of the two batteries will be different. Even when the battery is idle, due to the different degree of self-discharge, it will cause an imbalance between the batteries connected in series. During the charging process, due to the difference, one battery will be overcharged Or discharge, while the other is not fully charged or discharged. As the charge and discharge process is repeated, this difference will gradually intensify, eventually leading to premature battery failure.

How Does the Mazava® battery equalizer works?

Mazava® battery equalizer is an energy transfer equalizer that can compensate the battery in both directions. When the voltage difference between the batteries connected in series exceeds 10 millivolts, the battery equalizer starts to work, and the current will flow from the higher voltage battery to the lower voltage. The low battery will eventually balance the battery. It can be connected to the battery connected in series for a long time to automatically maintain the battery balance without maintenance.

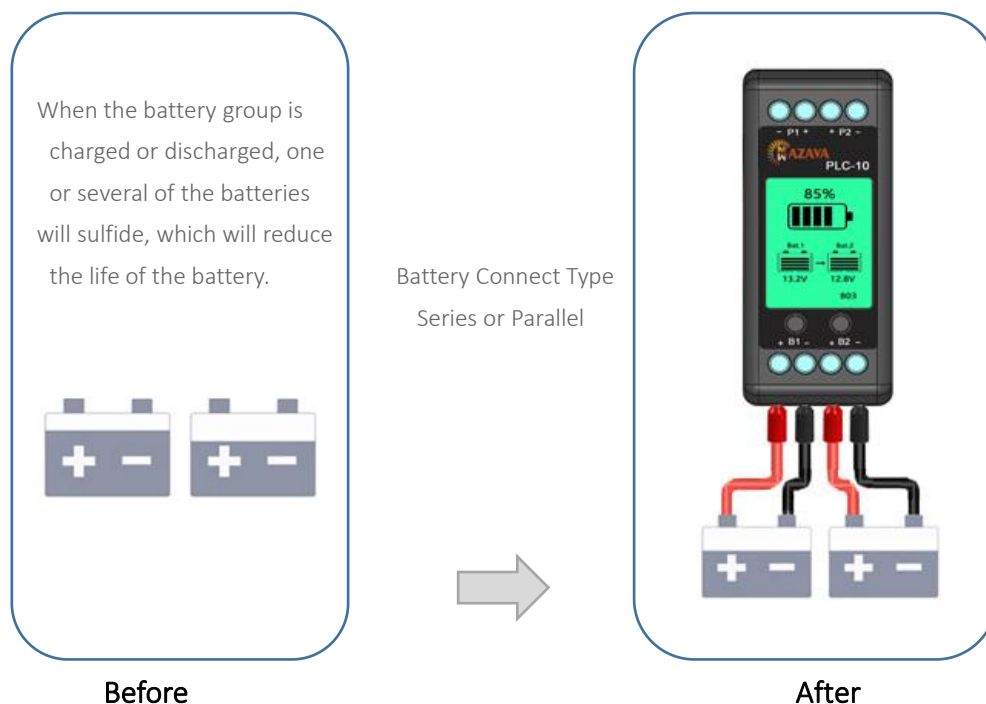

Mazava® battery equalizer is suitable for lead-acid batteries, Li-ion Battery batteries, Lithium iron phosphate Batteries, nickel-cadmium or nickel-hydrogen batteries. It can work when the voltage is higher than 7V, that is, the battery equalizer can be used for batteries with a single battery in the range of 7V-18V, and any number of batteries can be connected in parallel or series.

The battery equalizer can be installed in multiple parallel connections, and can be used with 48V 60V 72V 96V 110V 220V 240V batteries. Each battery equalizer corresponds to 2 batteries. Rail-type buckle installation, can easily install the module in the distribution box.

Two pairs of battery connection terminal wires and one pair of parallel wiring are included in the product package, which is convenient for customers to install quickly.



Before installing the Battery equalizer, please read the installation steps carefully to avoid damage to the device.

1. Before connecting the battery equalizer, please confirm the positive and negative poles of each battery to avoid short circuit and reverse connection between the battery equalizer terminals.

2. Please measure the voltages of the two batteries^① separately to ensure that the voltages of the two batteries are within the normal operating range.

3. Connect the battery equalizer B1+ and B1- terminal to Battery-1, and set the battery type. Long press SET button 5s (pic1), then the B00 will flash. Press the set or down button and choose correct battery model No (Default mode B03). After the button is not operated for 5 seconds, the system automatically saves and the battery voltage setting is completed, then connect the battery equalizer B2+ and B2- terminal to Battery-2. (pic.2)

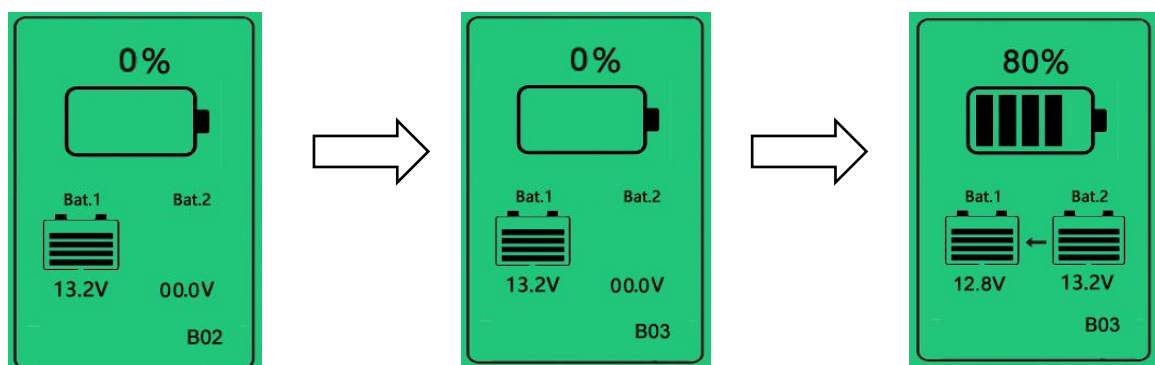

Pic.1



Bat-1 Bat-2



Bat-1 Bat-2 Bat-3 Bat-4

Pic.2

Pic.3

4. If need connect more battery,you could make connect several battery equalizer(pic3). please connect P1 and P2 terminals of two adjacent battery equalizers in parallel③.

- ① The two batteries in the battery pack must be of the same type. The capacity or the new old of the battery is different, which will affect the effect of the battery equalizer.
- ② Each equalizer corresponds to 2 batteries. When only one battery is connected, please connect to the B2 terminal of the equalizer. If it is connected to B1, it will not work normally.
- ③ Multiple battery equalizers can be used in parallel to solve the voltage balance of multiple batteries in the battery pack. In theory, countless batteries can be connected in parallel.

Battery Type Table:

Model No	Quantity of the cells	Rated Voltage	Battery Type	Max charge voltage:
B01	2S x 3.7V	7.4V	Lithium Ion Battery	8.4V
B02	3S x 3.7V	11.1V	Lithium Ion Battery	12.6V
B03	/	12V	Lead-acid battery	14.8V
B04	4S x 3.2V	12.8V	LiFePO4 Battery	14.4V
B05	4S x 3.7V	14.8V	Lithium Ion Battery	16.8V

*Default mode B03

Installation Wiring Diagram

① 2PCS Batteries Connect



② 3PCS Batteries Connect



③ 4PCS Batteries Connect

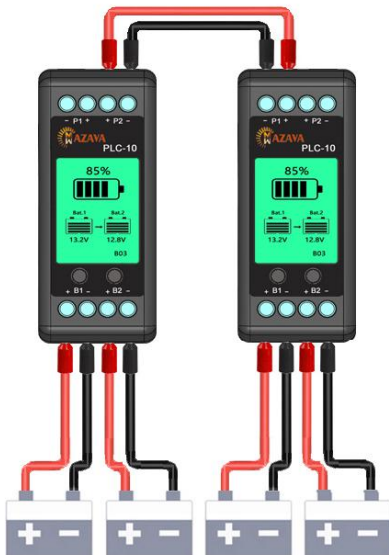

④ 6PCS Batteries Connect

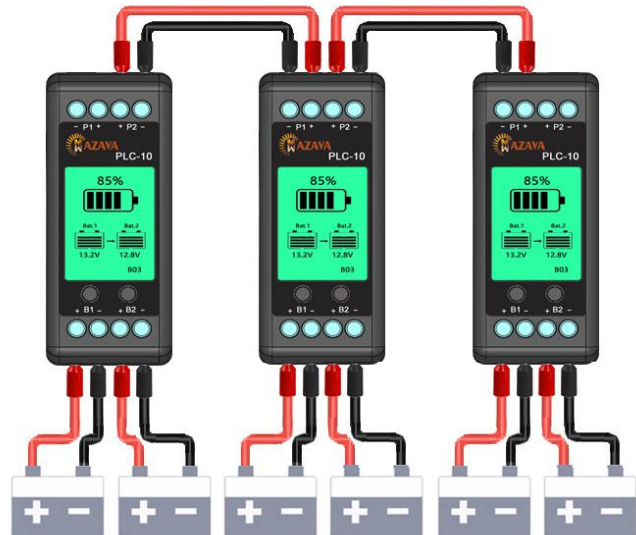

⑤ 8PCS Batteries Connect

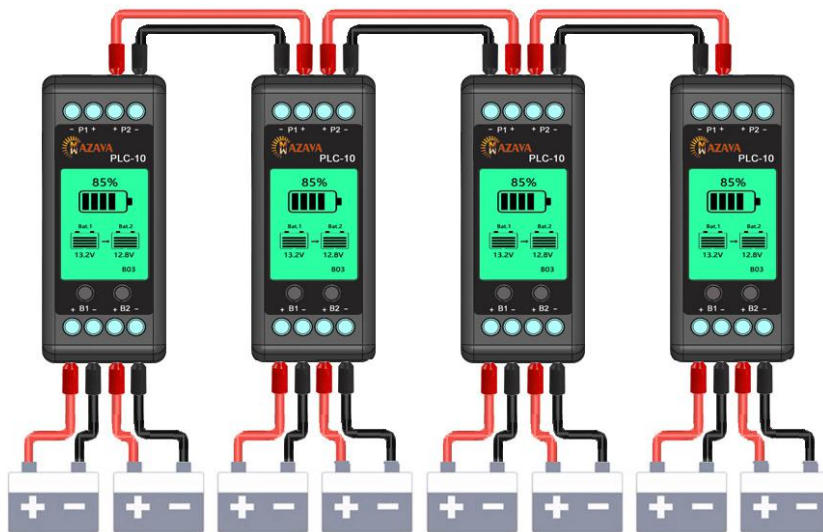

⑥ 10PCS Batteries Connect

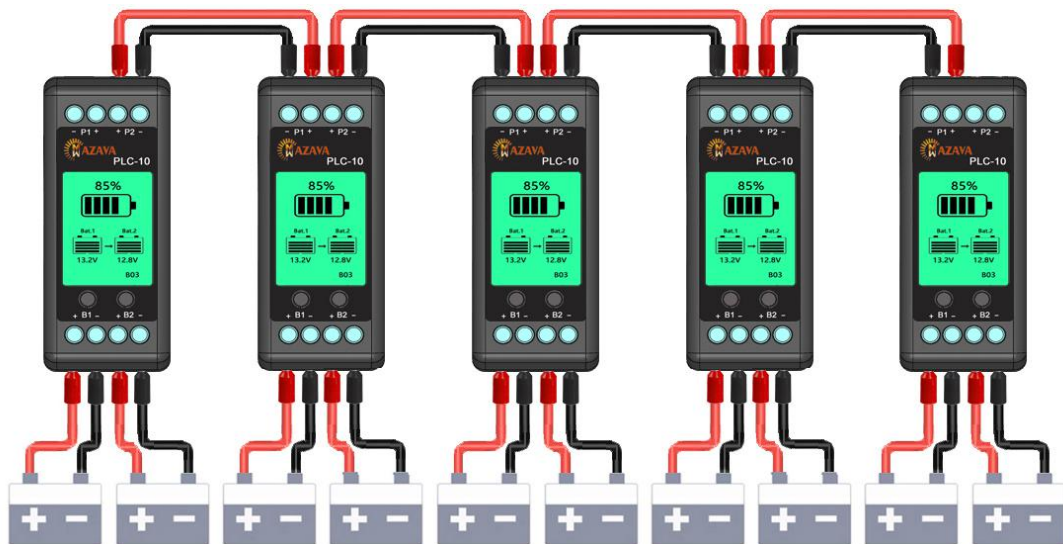

⑦ 12PCS Batteries Connect

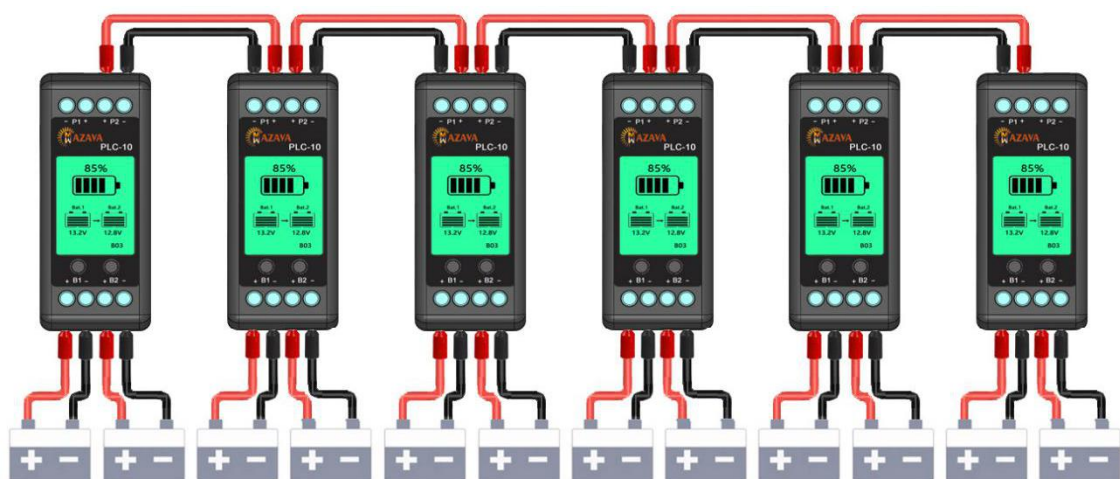

Mazava® battery equalizer Specification

Model No	PLC-10
LCD Display	Yes
Rated Voltage Scope	7-18V
Optimizing Current	0-10A
Quiescent Current	8mA
Connection method	Parallel Connect or Series Connect
Multi-module parallel connection	Support
Product Size	85*75*30mm
Product Weight	200g
Packing Quantity	50pcs/Ctn
Carton Size	56*35*27cm

Mechanical Dimension Diagram

